

Care and Maintenance

Student Devices

The following care and maintenance procedures, as listed in the 1:1 Acceptable Use Policy, can help prevent any damages to your ORS laptop and prevent you from incurring any future damage penalties.

Picking Up

Technology devices should never be picked up by the lid; they should only be lifted and held by the base. Lifting the devices by the screen can damage the display and the hinges. The display can also be scratched or damaged by direct pressure.



Covering

The school-issued device case should be used at all times. Many cases of device damage happen because laptops are dropped or bumped. Using the provided case greatly reduces the risk of damage.

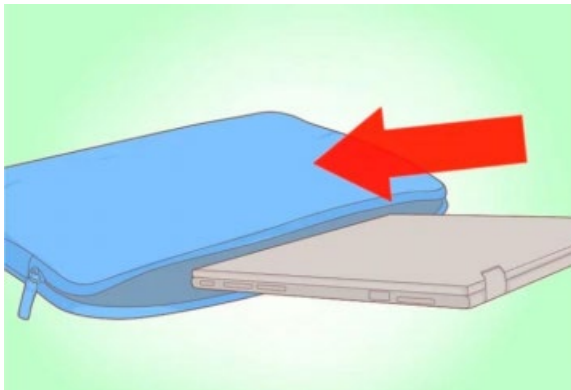

Always Store Indoors

Devices should be kept at room temperature and should not be exposed to extreme hot or cold. Do not leave your device inside a vehicle or outside.



Liquids and Food

Liquids and food should not be consumed in the vicinity of the device. Spilled liquids and food can damage the keyboard and cause short circuits.

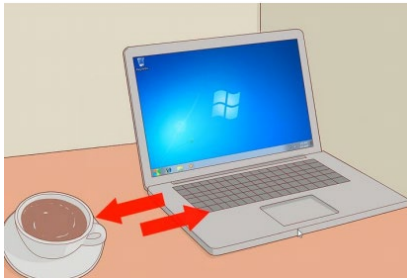

Tripping

Devices can be a tripping hazard when they are charging. Be careful to charge your device in such a manner that others will not trip over the wire.

